

# FORD FOCUS

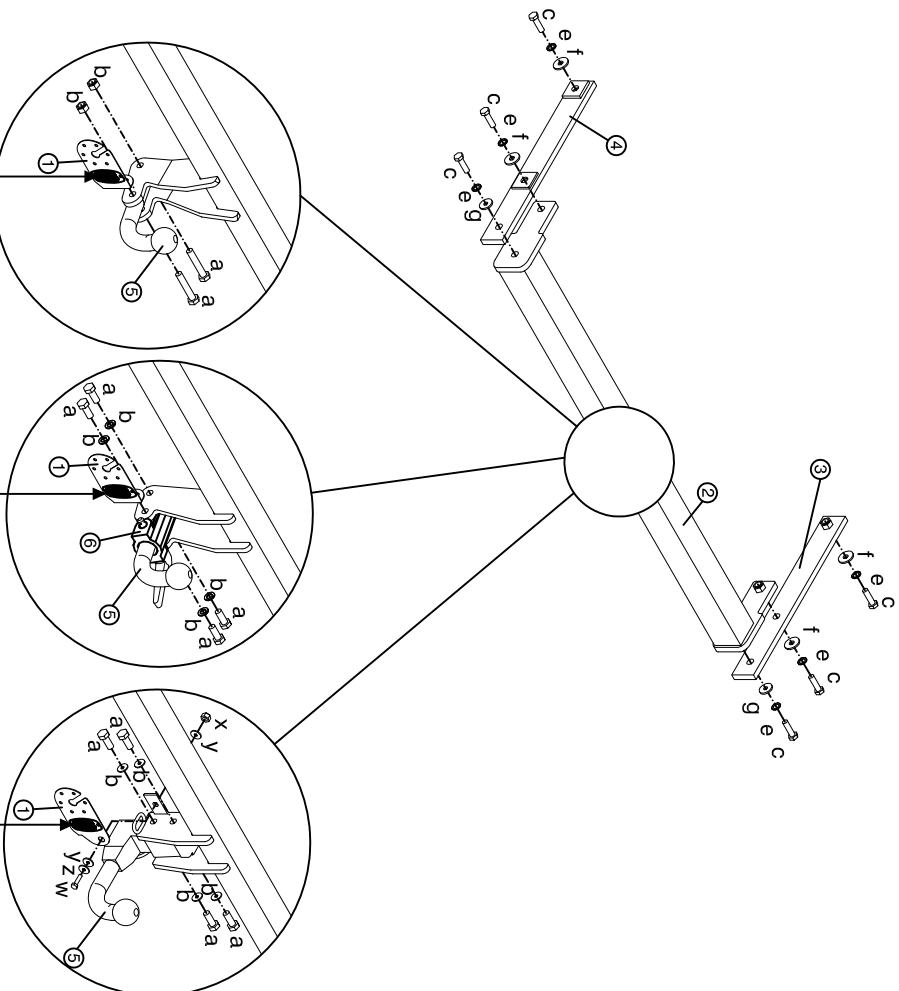

**E9** **lafuente**  
Made by LAFUENTE (SPAIN) Tlf: (+34) 922 625 840 www.lafuente.es

55R -01 2336  
D 11,00 kN  
S 100 kg  
TIPO EE0539  
CLASE A-50X

E9 55R -01/07 2338

**E9** **lafuente**  
Made by LAFUENTE (SPAIN) Tlf: (+34) 922 625 840 www.lafuente.es



55R -01 2339  
D 11,00 kN  
S 100 kg  
TIPO EE1539  
CLASE A-50X

E9 55R -01/07 2339

**E9** **lafuente**  
Made by LAFUENTE (SPAIN) Tlf: (+34) 922 625 840 www.lafuente.es







55R -01 2340  
D 11,00 kN  
S 100 kg  
TIPO EE4539  
CLASE A-50X

E9 55R -01/07 2340

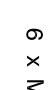
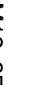
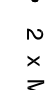
S		D	
	100 Kg.		11,00 kN

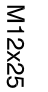

ECE R55  
homologación

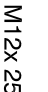
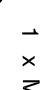
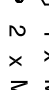
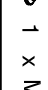
ELEMENTOS DE UNIÓN / CONNECTION COMPONENTS		DAZUGEHÖRENDEN TEILEN / ÉLÉMENTS DE RACCORD		VEHÍCULO / VEHICLE		FAHRZEUG / VÉHICULE		
BOLA / BALL / KUGEL / BOULE								
a		2 x	M12x65 DIN 931	8,8	c		6 x M12x50 DIN 933	8,8
b		2 x	M12 DIN 985	8	d		2 x M12 DIN 125	-
a		4 x	M12x25 DIN 933	8,8	e		6 x M12 DIN 6798	-
b		4 x	M12 DIN 127	-	f		4 x M12 DIN 9021	-
a		4 x	M12x 25 DIN 933	8,8	w		1 x M10x30 DIN 933	8,8
b		4 x	M12 DIN 127	-	x		1 x M10 DIN 985	8
					y		2 x M10 DIN 125	-
					z		1 x M10 DIN 2093	-

Par de apriete para los tornillos/Tightening torque for bolts/Schrauben Drehmoment/Couple de serrage pour vis

Und./Nm	M6		M8		M10		M12		M14		M16
	calibre	peso	1,25	1,5	1,25	1,75	1,5	1,25	1,75	1,5	2
8,8	11,3	27,3	54,0	57,0	93,0	97,0	101,0	148,0	159,0	230,0	
10,9	16,5	40,1	79,0	83,0	137,0	143,0	149,0	218,0	234,0	320,0	
12,9	19,3	46,9	93,0	98,0	160,0	167,0	174,0	255,0	274,0	395,0	

Este documento debe ser presentado en la I.T.V. junto con el certificado de montaje.

H.NOS.SANCHEZ-LAFUENTE,S.A. no asume ningún tipo de responsabilidad por daños causados por usos inadecuados.

Comprobar en el Certificado de Conformidad (COC) del vehículo las capacidades máximas de arrastre y carga vertical. See the Certificate Of Conformity (COC) of your vehicle or contact your dealer to verify the max. trailer weight of your car.



# FORD FOCUS



EE0539



EE1539



EE4539

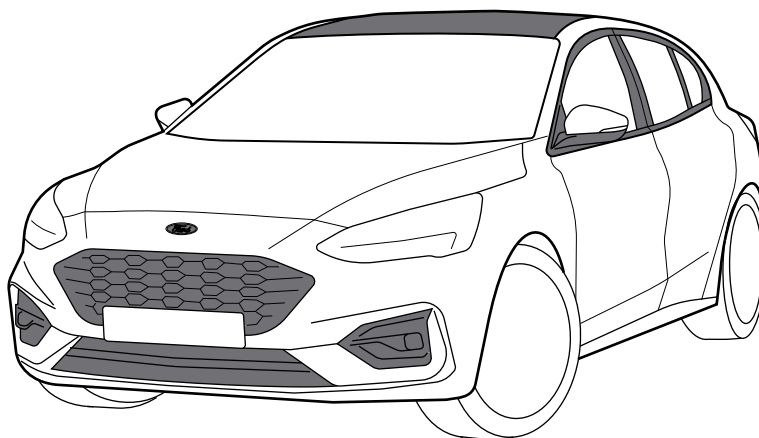

Instrucciones de montaje - Installation instructions - Notice de montage - Montage- og driftsvejledning

1

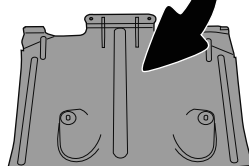
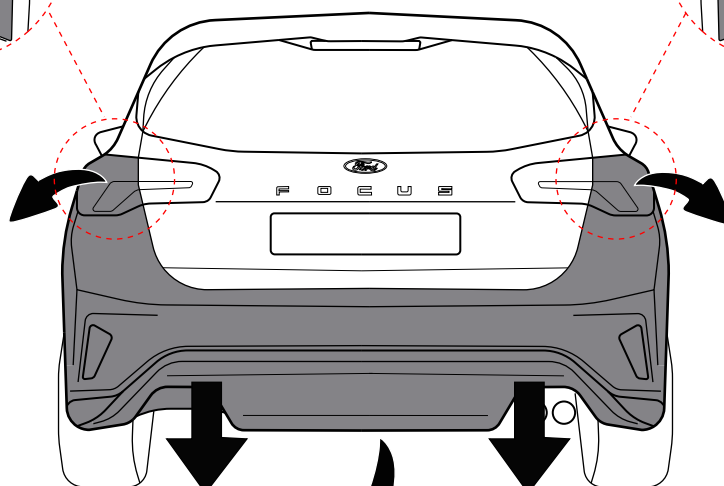
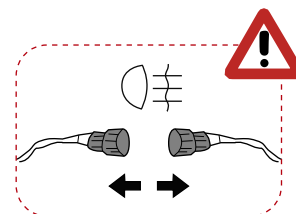
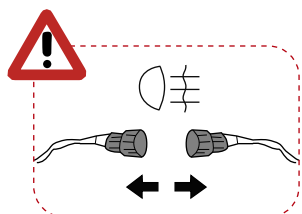
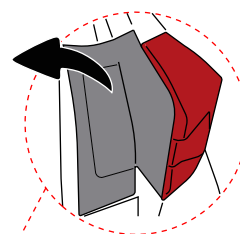
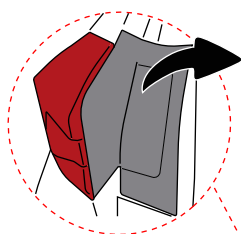

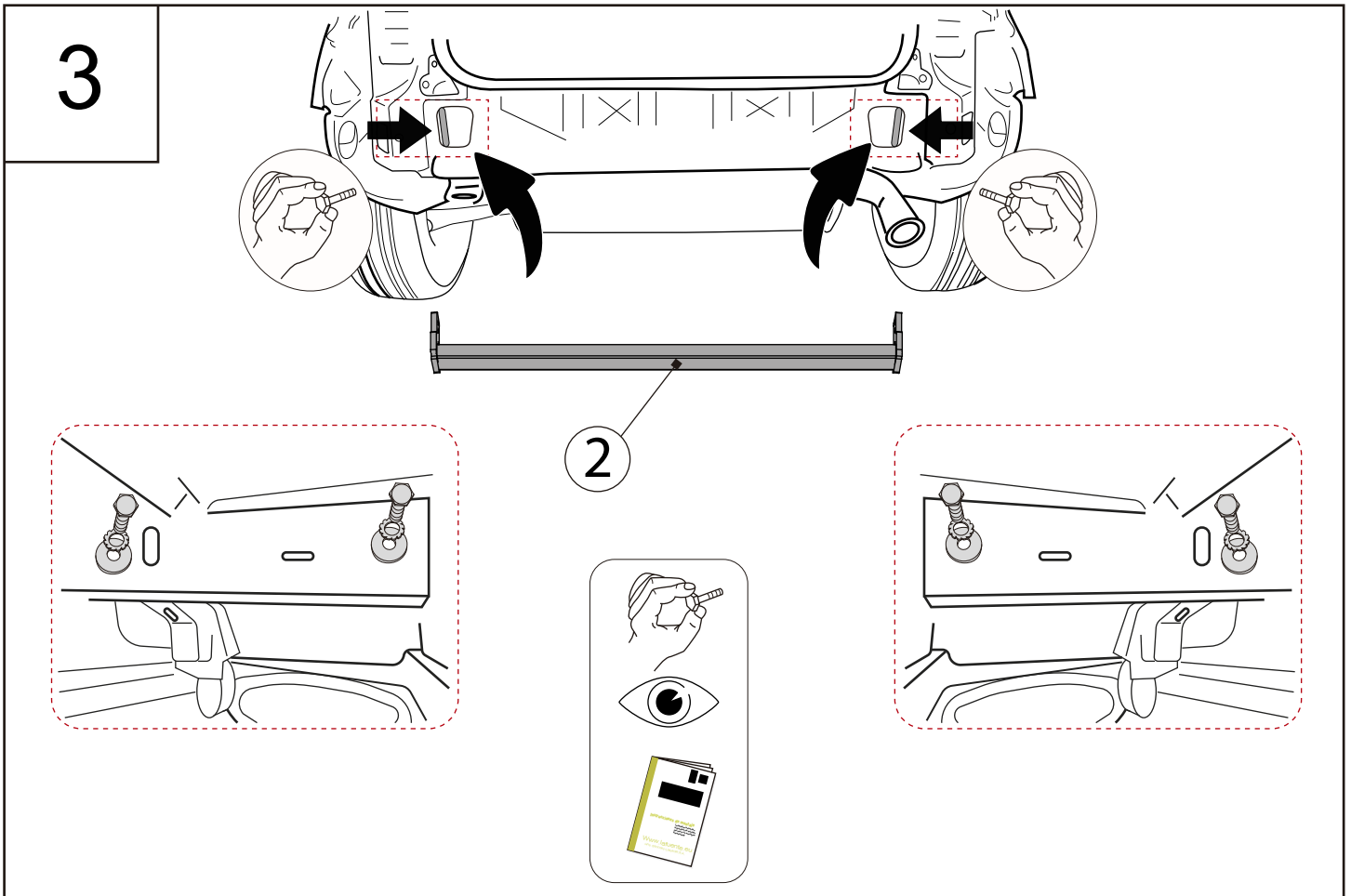
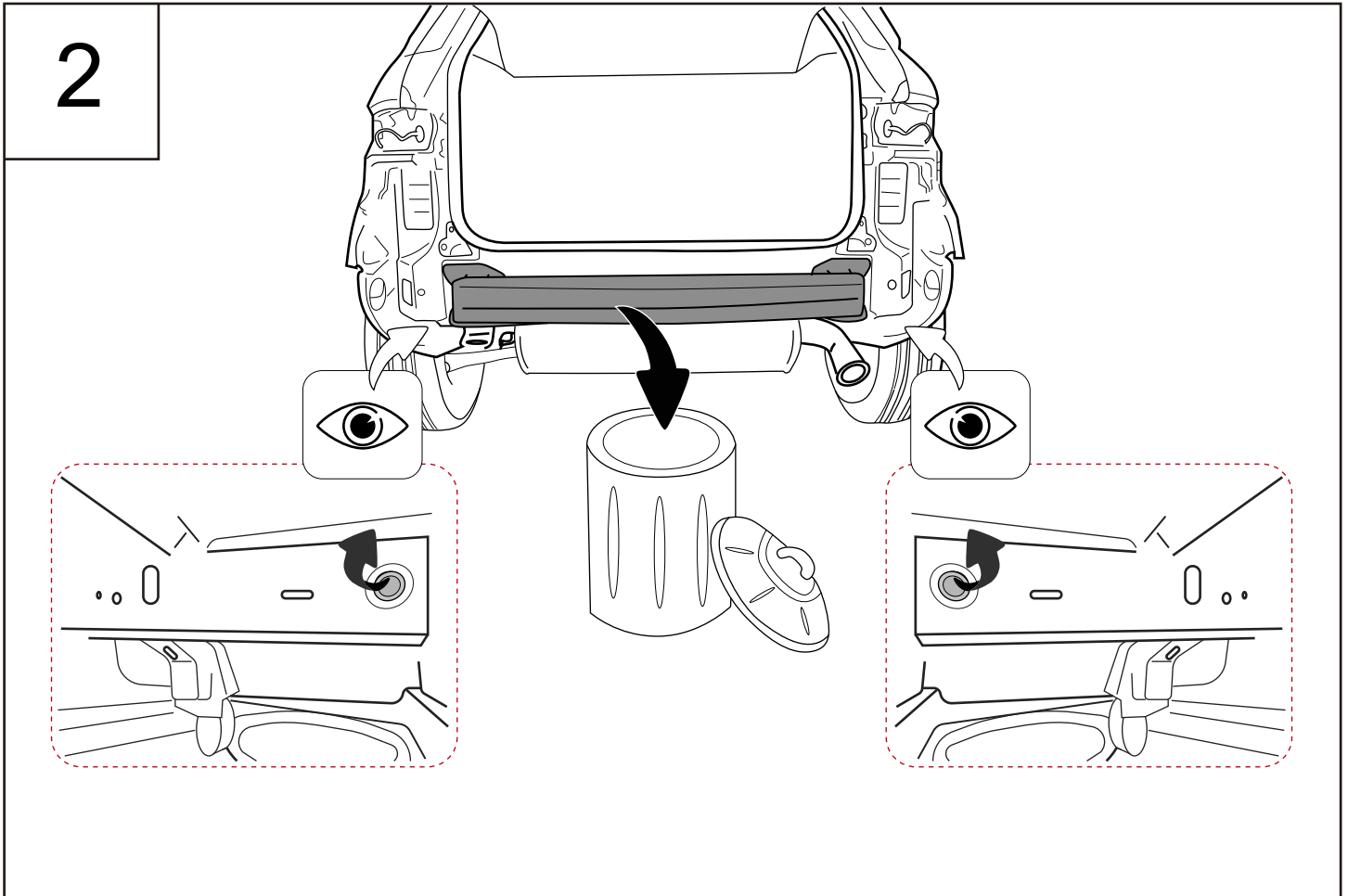

4

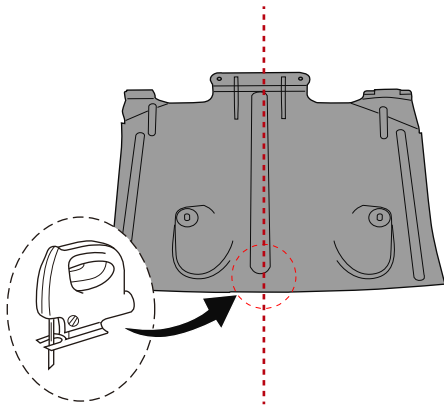
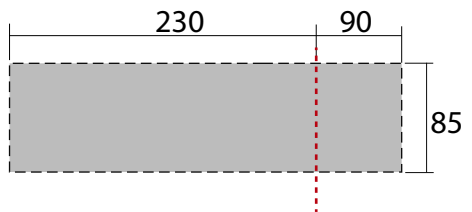
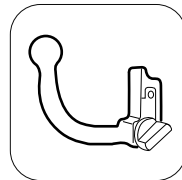
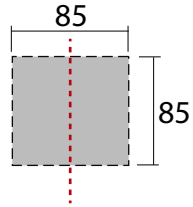
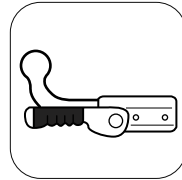
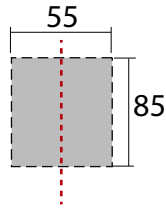
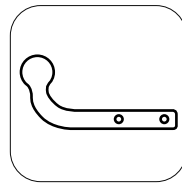

5

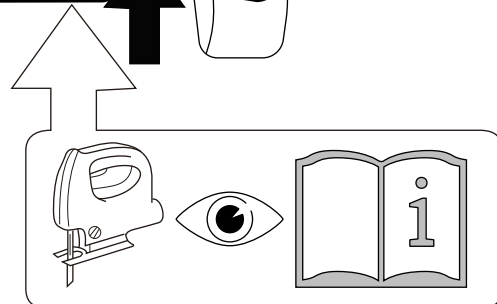
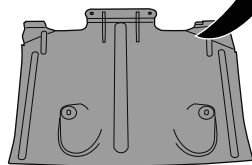
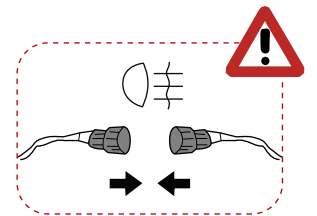
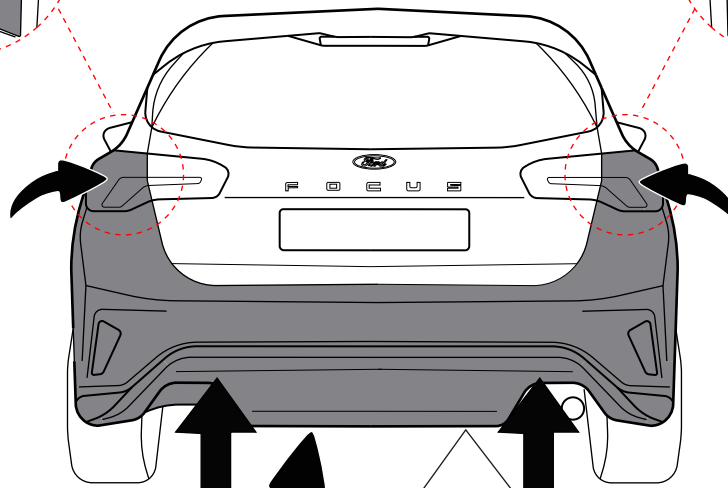
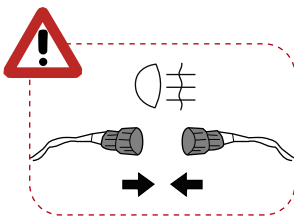
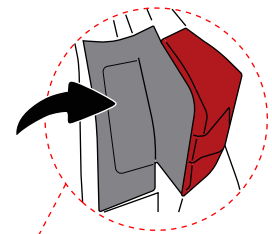
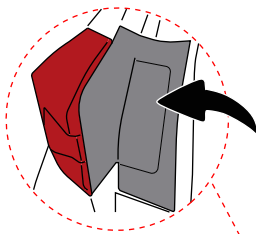

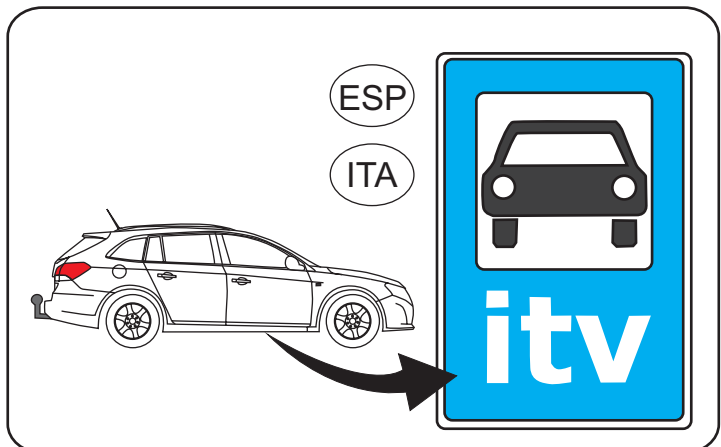
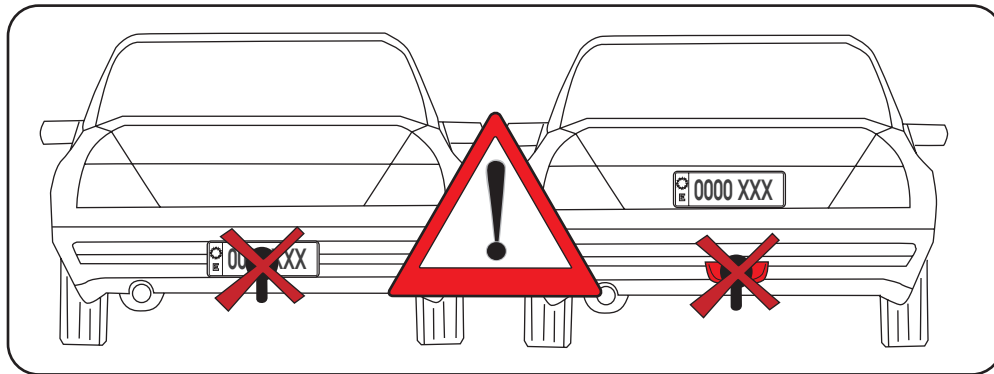
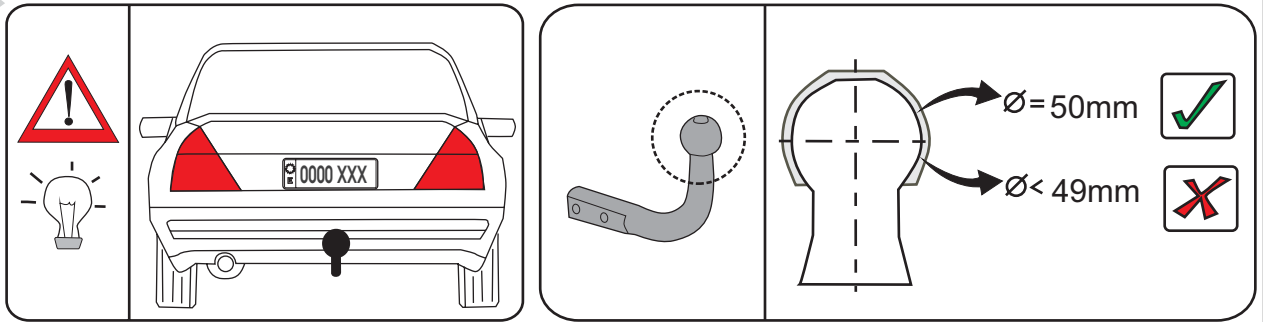
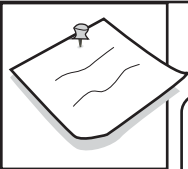

	M6	M8	M10	M12	M14	M16
8.8	10,4Nm	25,0Nm	51,0Nm	87,0Nm	140,0Nm	215,0Nm
10.9	15,5Nm	37,0Nm	75,0Nm	130,0Nm	205,0Nm	310,0Nm
12.9	18,0Nm	43,0Nm	87,0Nm	150,0Nm	240,0Nm	370,0Nm