



SEAT LEON SKODA SUPERB SKODA SUPERB COMBI SKODA OCTAVIA SEDAN SKODA OCTAVIA COMBI SKODA SCOUT COMBI AUDI A3 SPORTBACK	Nº de homologación Official approval number Prüfung Nr. Nº d'homologation
 EE0232	e9*94/20*94/20*8023*02
 EE1232	e9*94/20*94/20*8024*02



**lafuente**  
enganches y remolques

e9 00\*8023

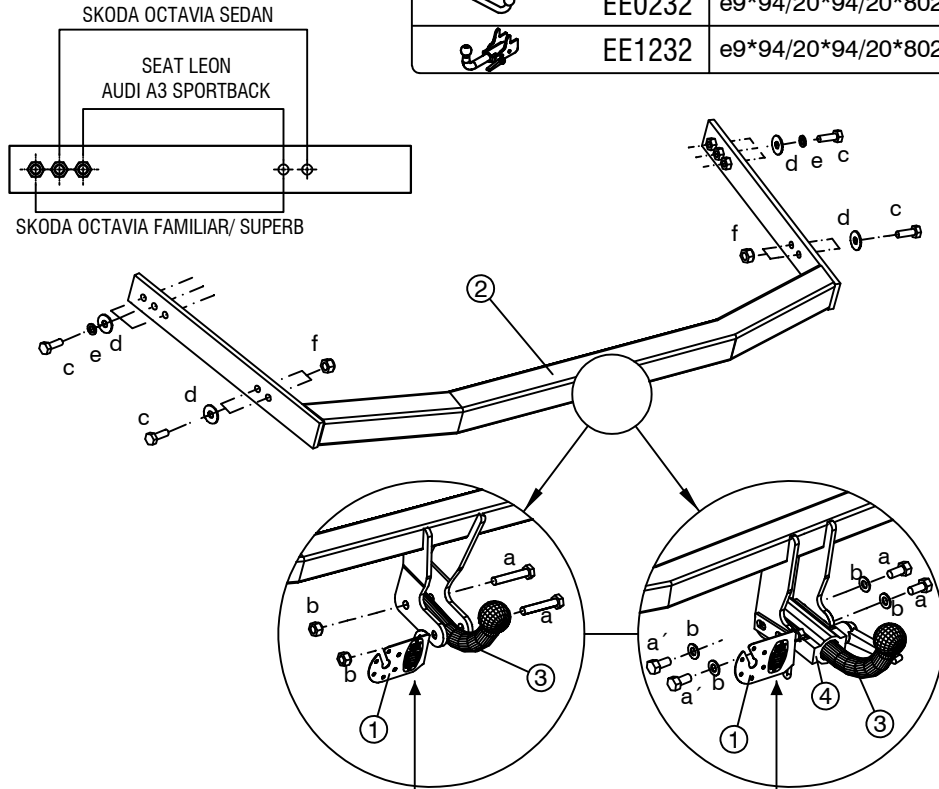
TIPO EE0232

CLASE A-50X

D 9,71 kN

S 80 kg

Made by LAFUENTE (SPAIN)  
Tlf. (+34) 952 625 840  
www.lafuente.eu

**lafuente**  
enganches y remolques

e9 00\*8024



TIPO EE1232

CLASE A-50X

D 9,71 kN

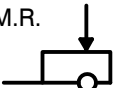

S 80 kg

Made by LAFUENTE (SPAIN)  
Tlf. (+34) 952 625 840  
www.lafuente.eu

M.M.R. 	S 	D
1.950 kg.	80 kg.	9,71 kN

Par de apriete para los tornillos Tightening torque for bolts Schrauben Drehmoment Couple de serrage pour vis						
mm	6	8	10	12	14	16
Nm	10	25	55	85	135	200

Enganche homologado según Directiva 94/20 CE.  
Hitch officially approved in accordance with Directive 94/20 CE.  
Geprüfte Kupplung gemäß Kennzeichen 94/20 CE.  
Crochet homologué selon la Directive 94/20 CE.

ELEMENTOS DE UNIÓN / CONNECTION COMPONENTS DAZUGEHÖRENDENDEN TEILEN / ÉLÉMENTS DE RACCORD					
BOLA / BALL / KUGEL / BOULE			VEHÍCULO / VEHICLE FAHRZEUG / VÉHICULE		
					
a	2 x	M12x65 DIN 931	8.8	c	4 x M10x40 DIN 933 8.8
b	2 x	M12 DIN 985	8	d	4 x M10 DIN 9021 -
				e	2 x M 10 DIN 127 -
					
a	2 x	M12x25DIN 933	8.8	f	2 x M10 DIN 985 8
a'	2 x	M12x30 DIN 933	8.8		
b	4 x	M12 DIN 125	-		

Este documento debe ser presentado en la I.T.V. junto con el certificado de montaje.  
HNOS.SÁNCHEZ-LAFUENTE,S.A. no asume ningún tipo de responsabilidad por daños causados por usos inadecuados.

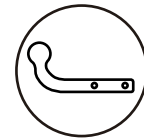

EE0232

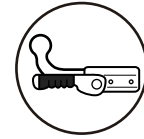

EE1232

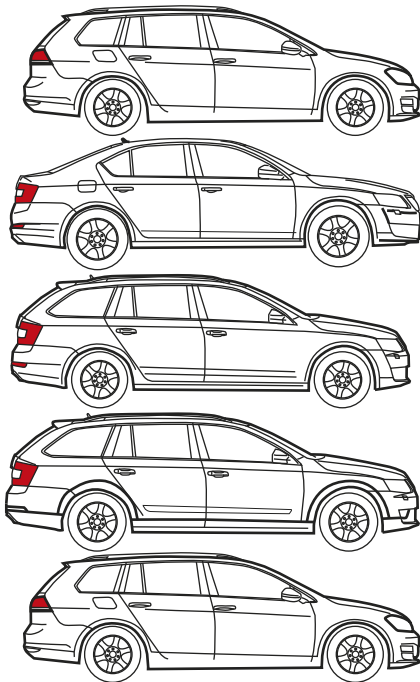

**SEAT LEON**  
**SKODA OCTAVIA SEDAN**  
**SKODA OCTAVIA COMBI**  
**SKODA SUPERB**  
**SKODA SUPERB COMBI**  
**AUDI A3 SPORTBACK**

Instrucciones de montaje - Installation instructions - Notice de montage - Montage- og driftsvejledning

1

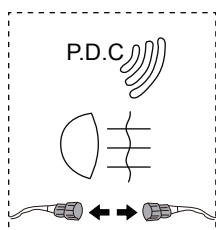
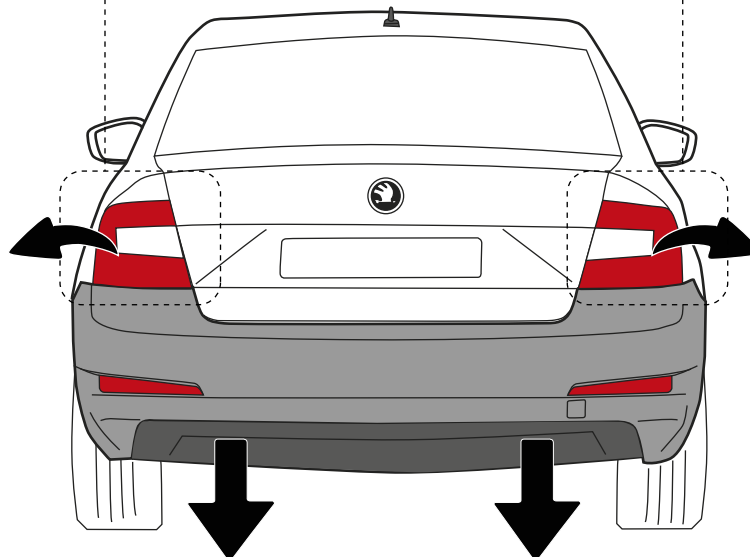
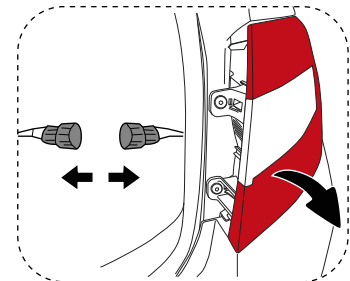
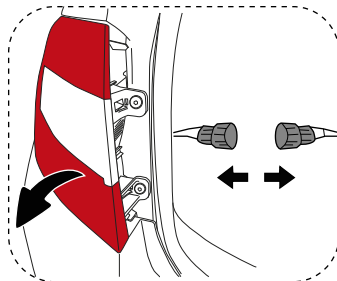

2



**SKODA**

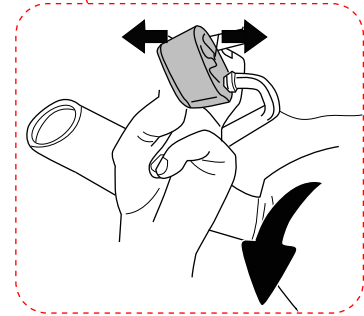
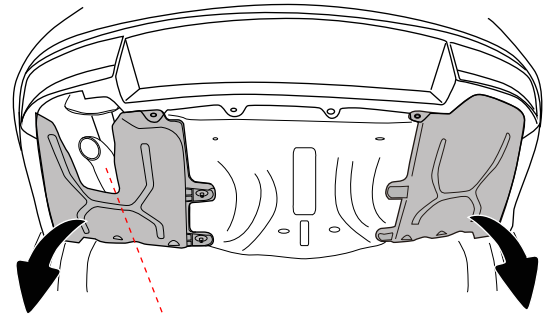
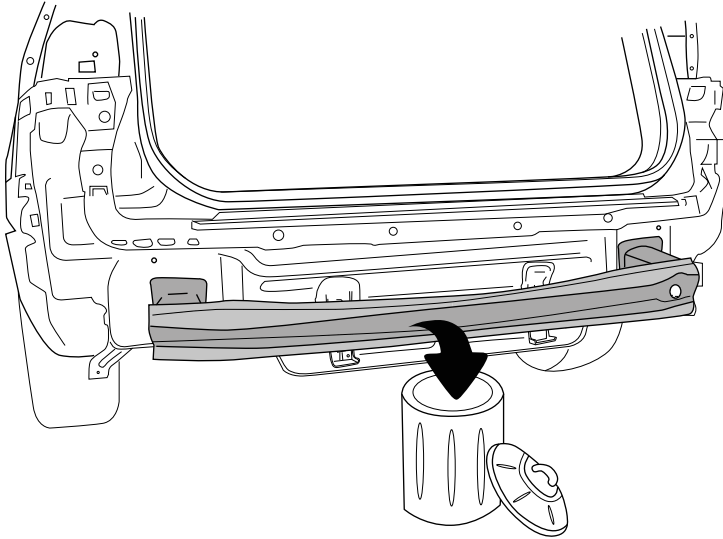

3

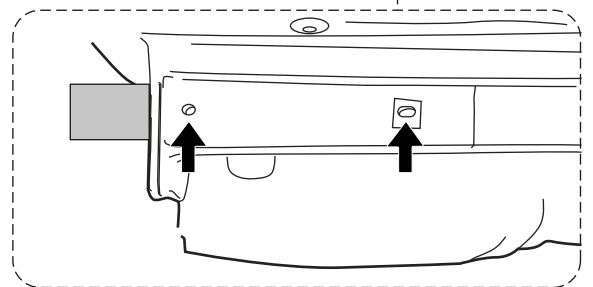
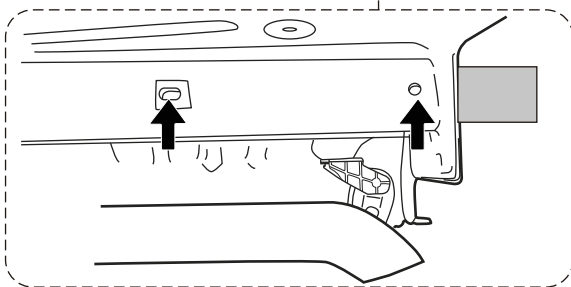
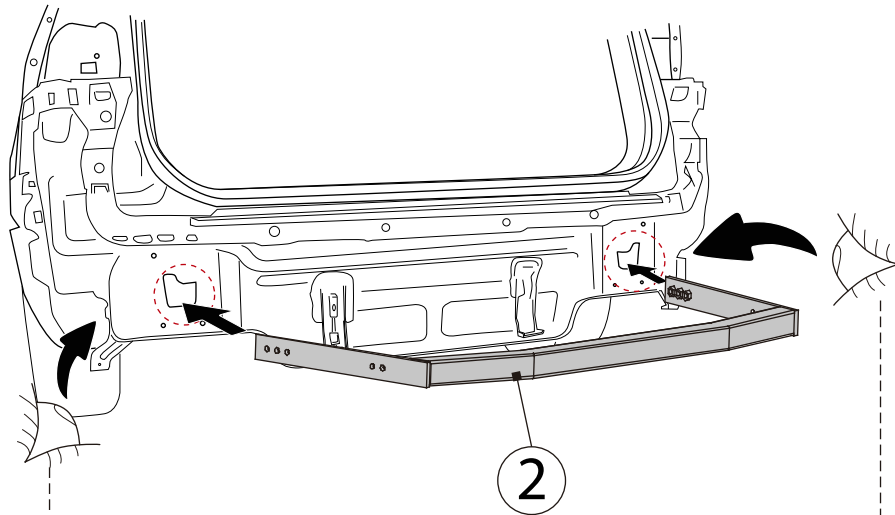

4

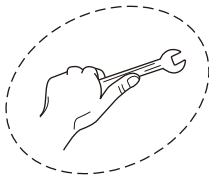

	M6	M8	M10	M12	M14	M16
8.8	10,4Nm	25,0Nm	51,0Nm	87,0Nm	140,0Nm	215,0Nm
10.9	15,5Nm	37,0Nm	75,0Nm	130,0Nm	205,0Nm	310,0Nm
12.9	18,0Nm	43,0Nm	87,0Nm	150,0Nm	240,0Nm	370,0Nm

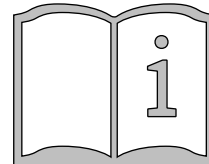
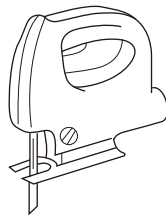
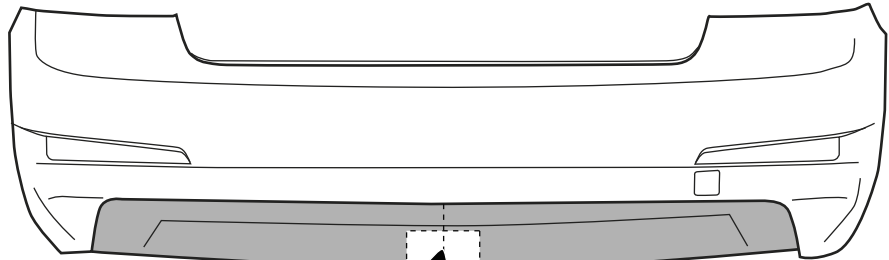

5

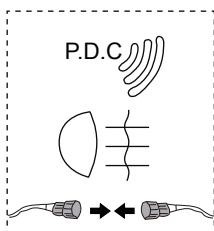
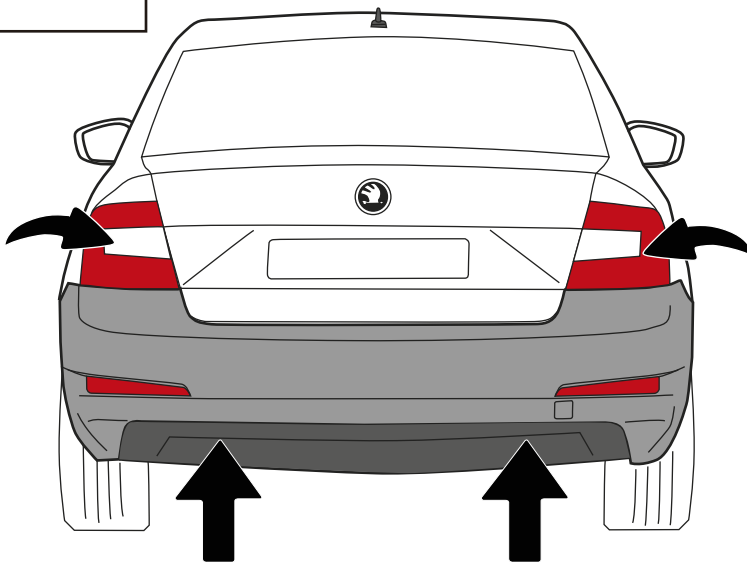

**SKODA**

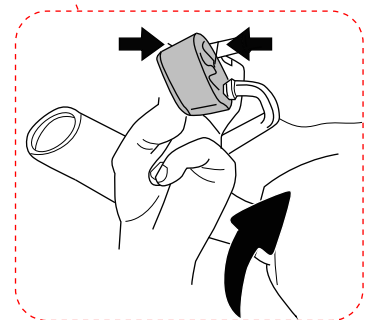
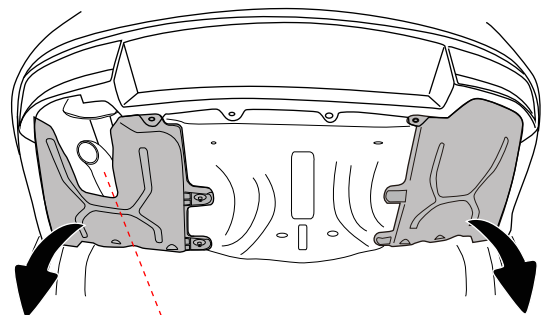

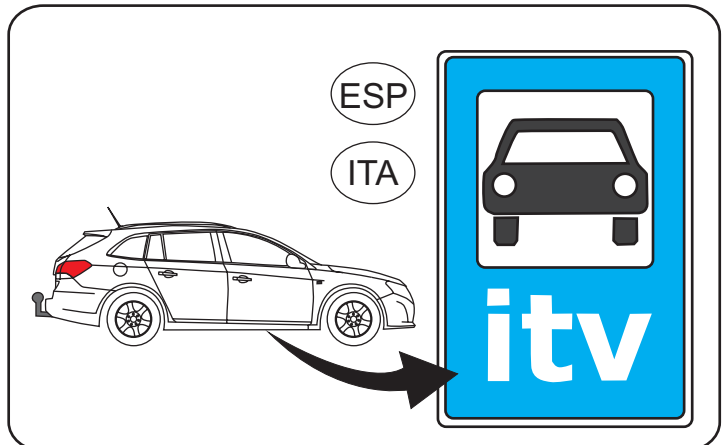
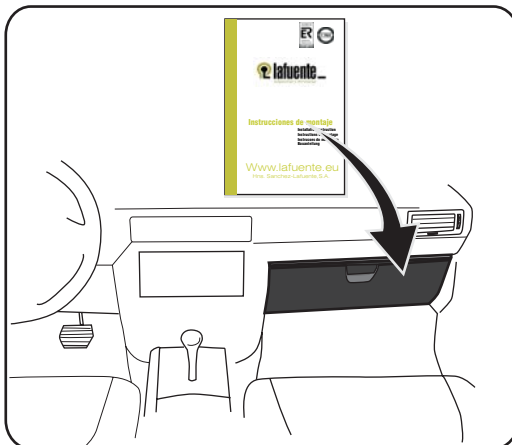
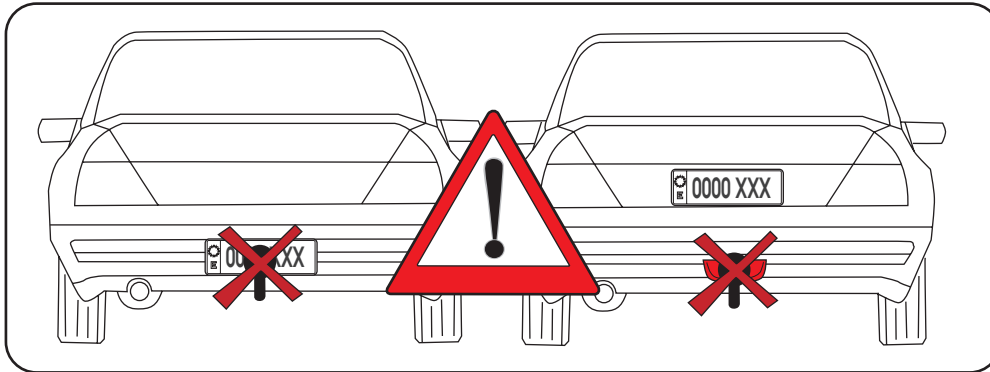
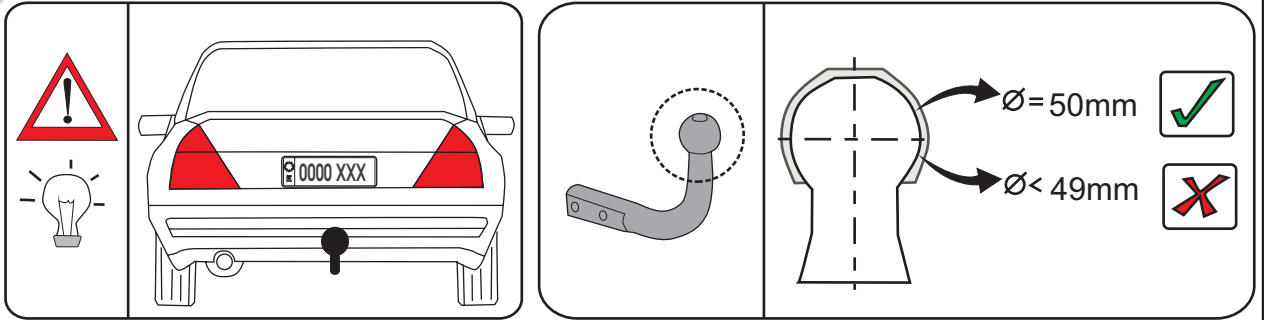
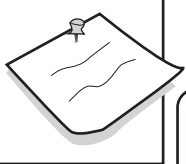

	M6	M8	M10	M12	M14	M16
8.8	10,4Nm	25,0Nm	51,0Nm	87,0Nm	140,0Nm	215,0Nm
10.9	15,5Nm	37,0Nm	75,0Nm	130,0Nm	205,0Nm	310,0Nm
12.9	18,0Nm	43,0Nm	87,0Nm	150,0Nm	240,0Nm	370,0Nm

# SKODA OCTAVIA BERLINA (2004-2013)

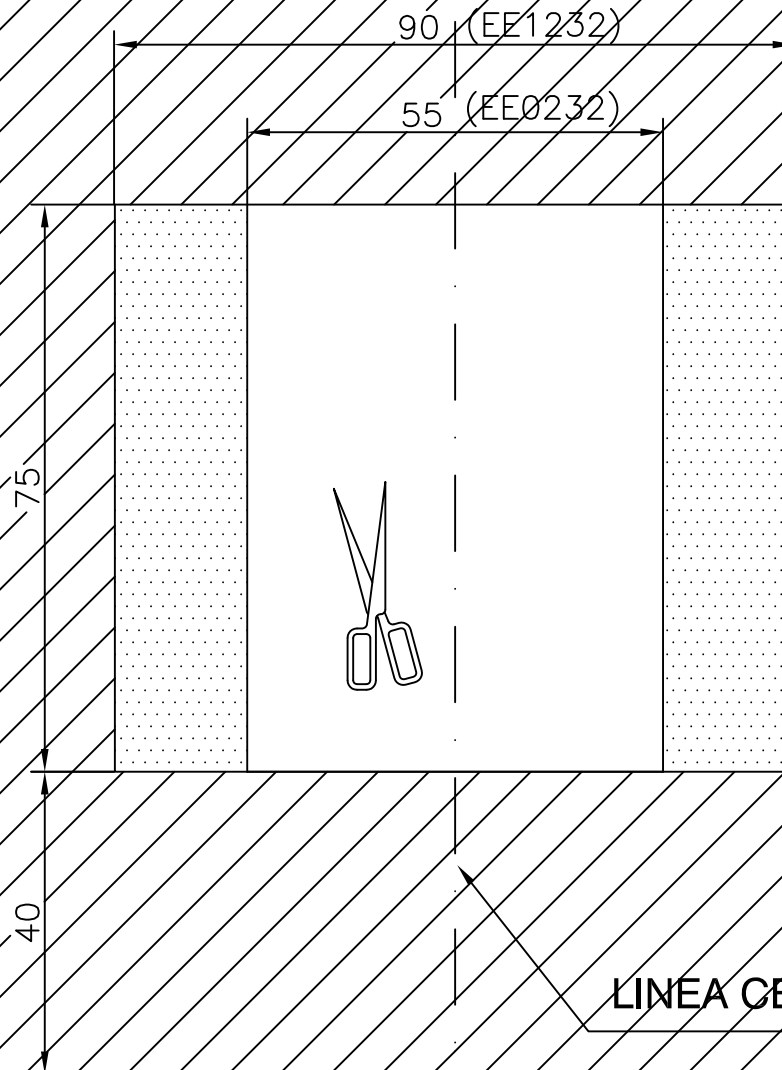

EE0232

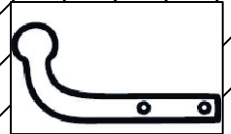

EE1232

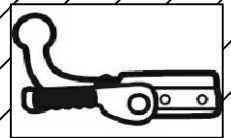

LINEA CENTRAL DEL PARAGLPPES



ESP: El corte es orientativo  
UK: The cut is indicative



Dibujo:  
CORTE PARAGOLPES  
SKODA OCTAVIA BERLINA

Escala:  
1:1

UNIDADES EN  
mm

EE0232-EE1232

Rev.  
P1

# SKODA OCTAVIA BERLINA (2013-...)

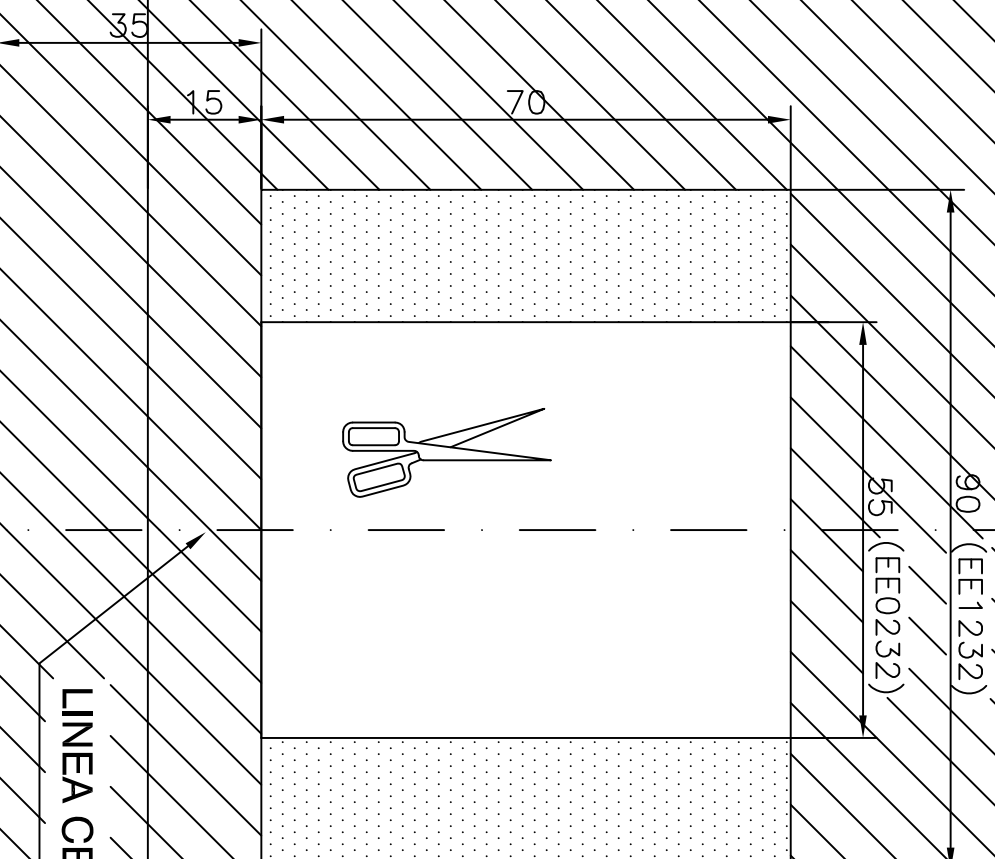

LINEA CENTRAL DEL PARAGLPPES

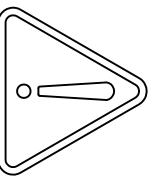

ESP: El corte es orientativo  
UK: The cut is indicative



Dibujo:

CORTE PARAGOLPES  
SKODA OCTAVIA BERLINA

Escala:  
1:1 UNIDADES EN  
mm

EE02332-EE12332

Rev.  
P1



# SKODA OCTAVIA COMBI (2004-2013)

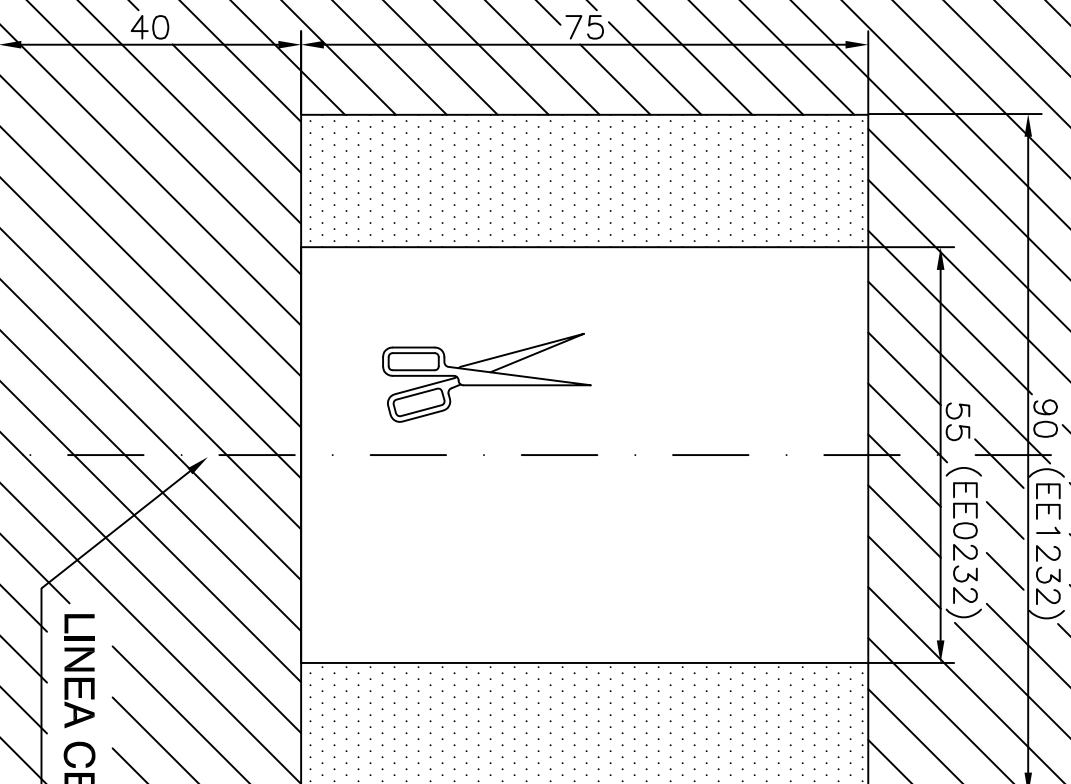

EE0232

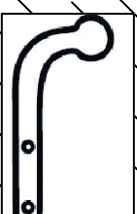

EE1232



LINEA CENTRAL DEL PARAGLAPES

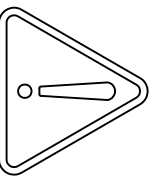

ESP: El corte es orientativo  
UK: The cut is indicative



Dibujo:

CORTE PARAGOLPES  
SKODA OCTAVIA COMBI

Escala:  
1:1

UNIDADES EN  
mm

EE0232-EE1232

Rev.  
P1



# SKODA OCTAVIA COMBI (2013-...)

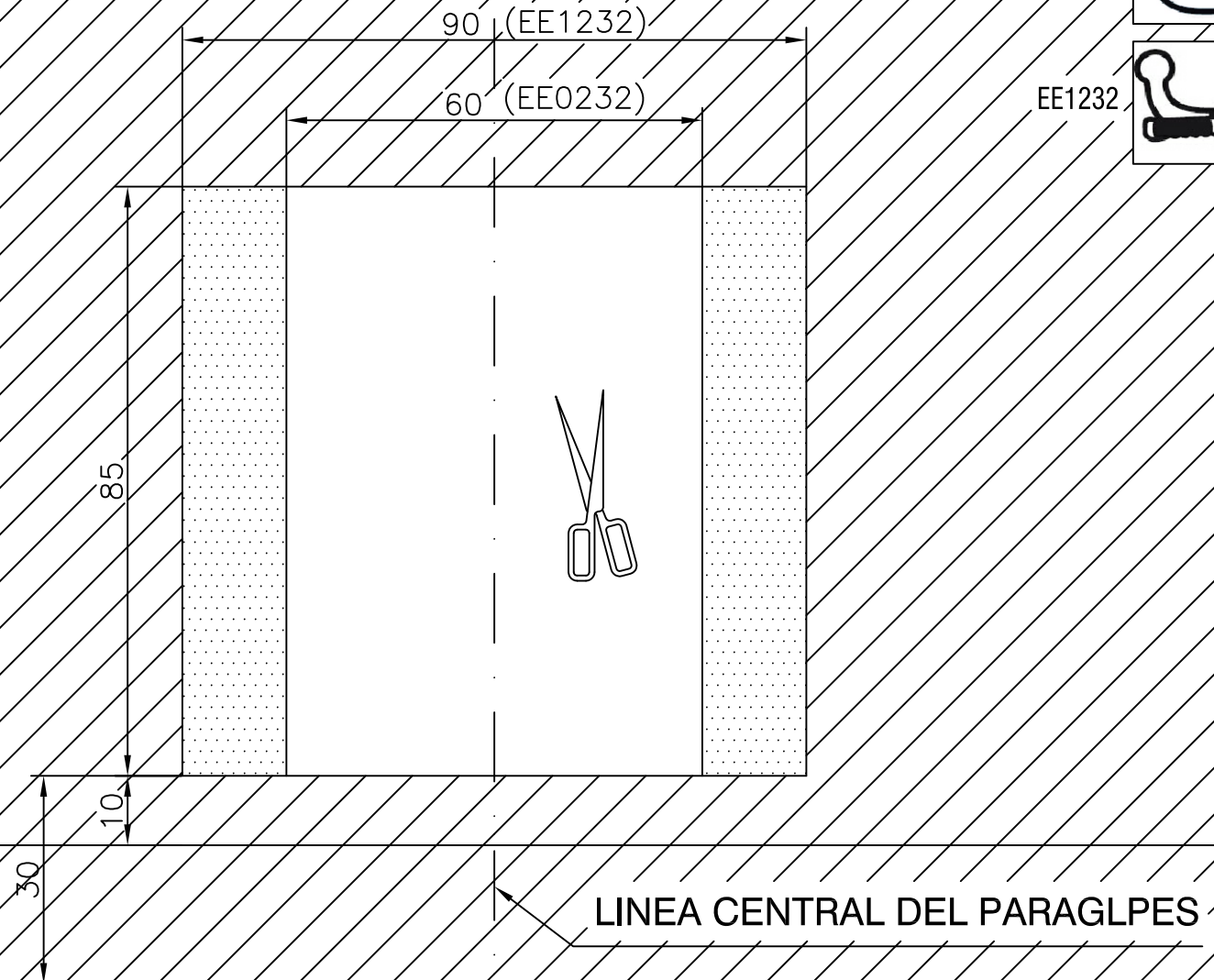

EE0232

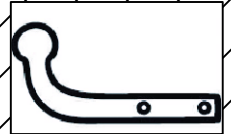

EE1232

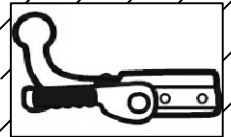

ESP: El corte es orientativo  
UK: The cut is indicative



Dibujo:  
CORTE PARAGOLPES  
SKODA OCTAVIA COMBI

Escala:  
1:1

UNIDADES EN  
mm

EE0232-EE1232

Rev.  
P1

# SKODA OCTAVIA COMBI VRS

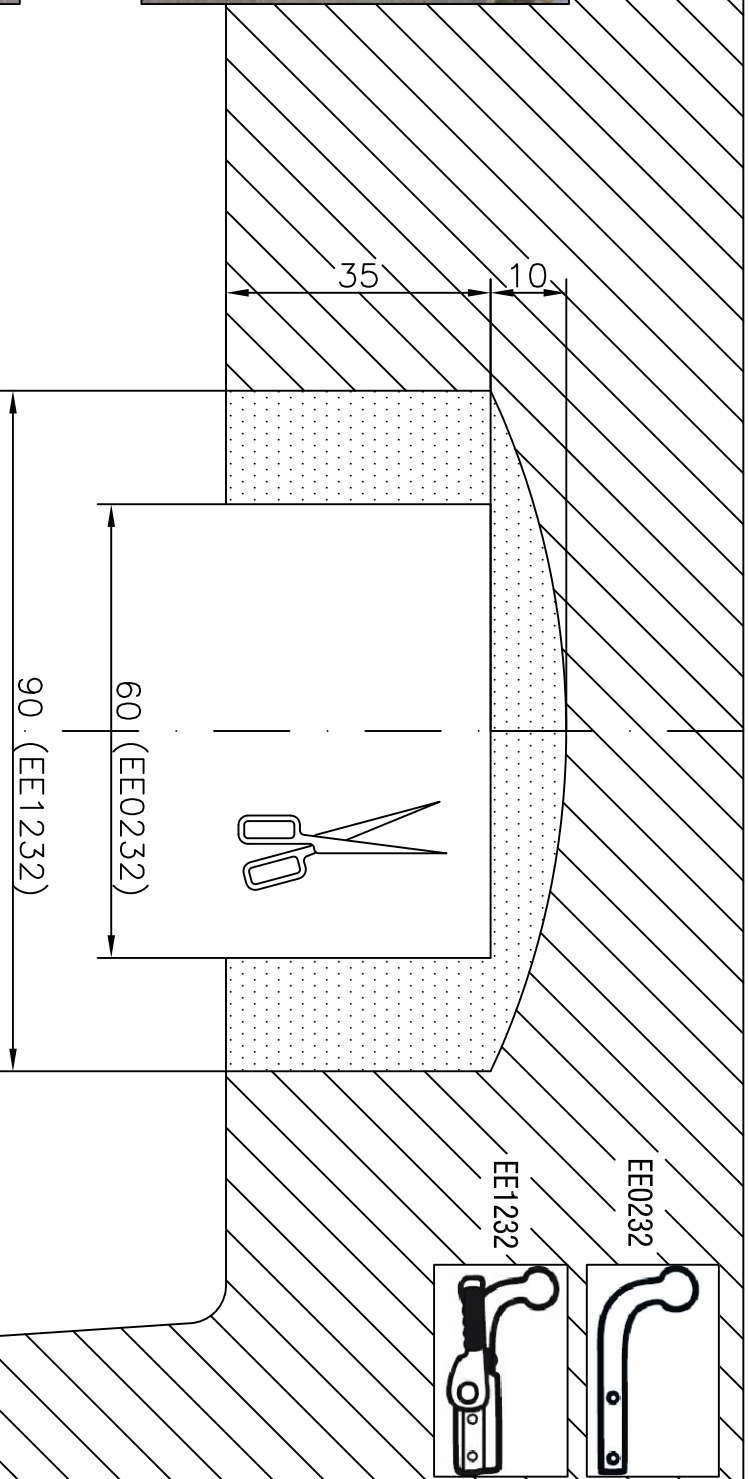

LINEA CENTRAL  
DEL PARAGLPPES

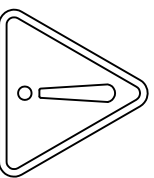

ESP: El corte es orientativo  
UK: The cut is indicative



Dibujo:

CORTE PARAGOLPES  
SKODA OCTAVIA COMBI VRS

Escala:  
1:1

UNIDADES EN  
mm

EE0232-EE1232

Rev.  
P1

# SKODA SUPERB BERLINA



EE0232

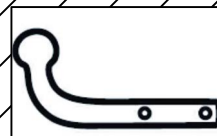

EE1232

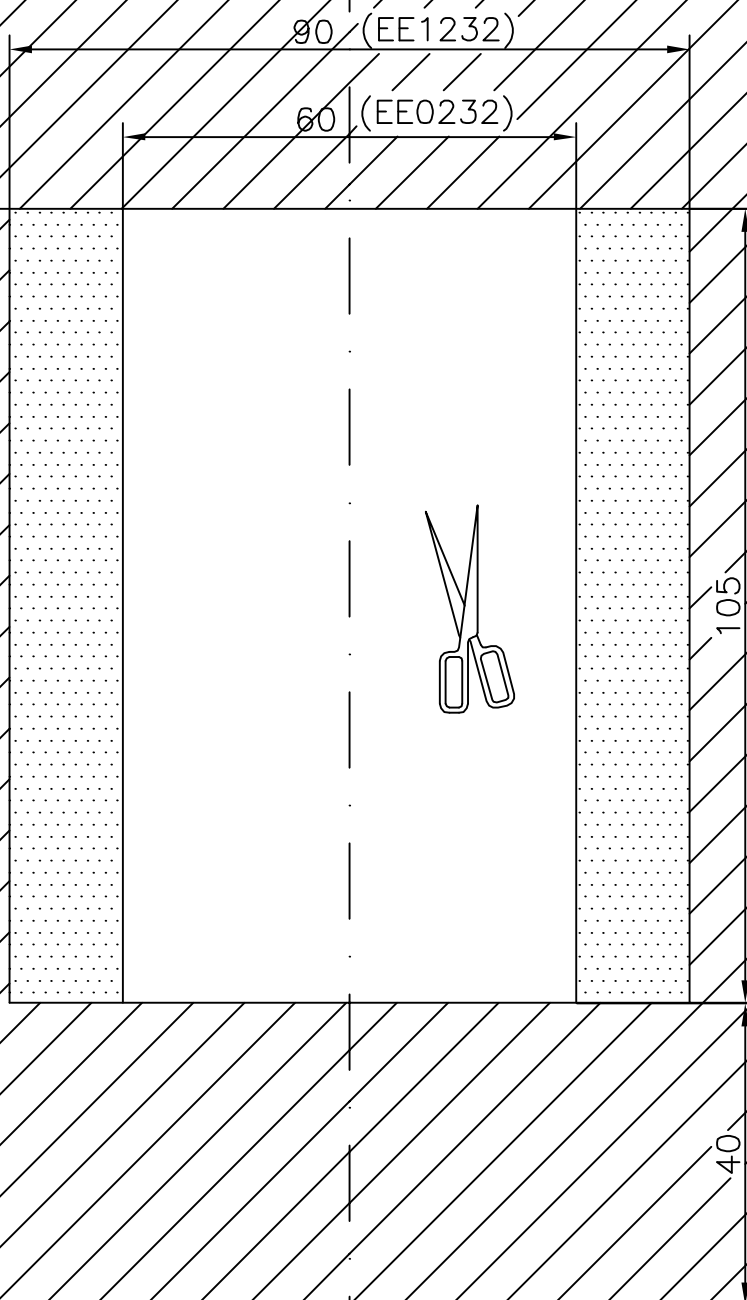

ESP: El corte es orientativo  
UK: The cut is indicative



Dibujo:

CORTE PARAGOLPES  
SKODA SUPERB BERLINA

Escala:  
1:1

UNIDADES EN  
mm

EE0232-EE1232

Rev.  
P1

# SKODA SUPERB COMBI



EE0232

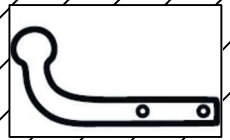

EE1232

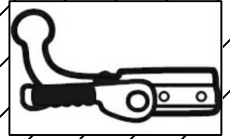

100 (EE1232)

70 (EE0232)

115

25



ESP: El corte es orientativo  
UK: The cut is indicative



Dibujo:  
CORTE PARAGOLPES  
SKODA SUPERB COMBI

Escala:  
1:1

UNIDADES EN  
mm

EE0232-EE1232

Rev.  
P1



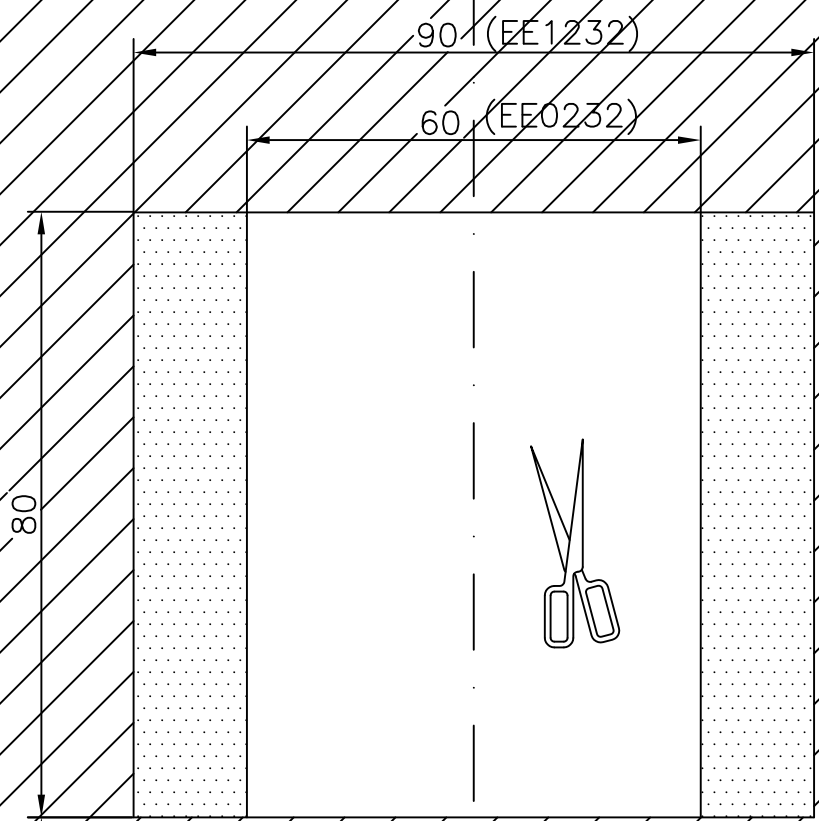

EE0232

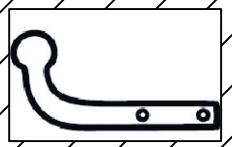

EE1232

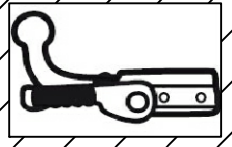

LÍNEA CENTRAL DEL PARAGLPPES

SEAT LEON

130



ESP: El corte es orientativo  
 UK: The cut is indicative



Dibujo:  
 CORTE PARAGLPPES  
 SEAT LEON

Escala:  
 1:1

UNIDADES EN  
 mm

EE0232-EE1232

Rev.  
 P1

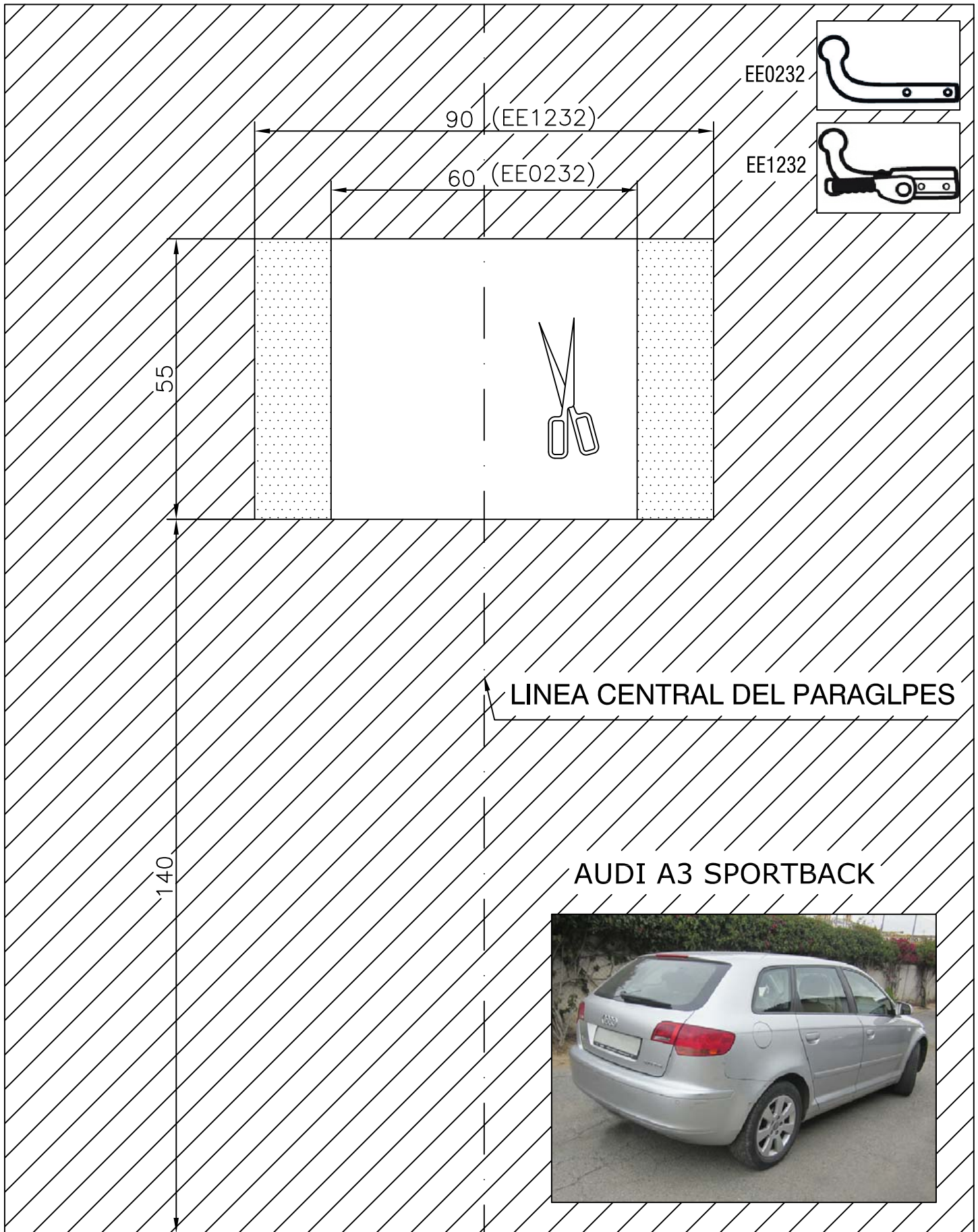

AUDI A3 SPORTBACK



ESP: El corte es orientativo  
 UK: The cut is indicative



Escala: 1:1 UNIDADES EN mm

Dibujo: CORTE PARAGOLPES  
 AUDI A3 SPORTBACK

EE0232-EE1232

Rev. P1